

# ZUMA BUSINESS PARK

10,000 Square Feet of Industrial Suites

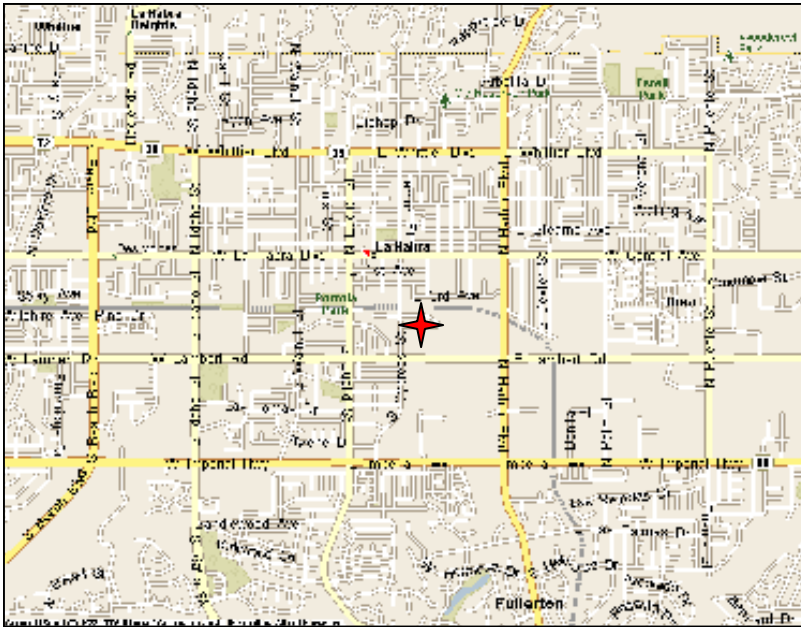

431 Commercial Way - La Habra, CA



## *Property Features:*

### *Industrial Units:*

- *Well Maintained Industrial Building*
- *Gate d parking with 24 hour access*
- *Responsive Management*
- *Units range between 1,400 to 2,700 sf*
- *10% to 25% improved office area*
- *16' to 18' warehouse clearance*
- *100 amp power*
- *Near Harbor Boulevard and Imperial Highway*

### *For Leasing Information Please Contact:*

Leasing Office (714) 237-7032

Susan Lee—slee@cedarem.com

www.cedarem.com

4055 La Palma Ave., Suite H-1, Anaheim, CA 92807



# ZUMA BUSINESS PARK

431 Commercial Way—La Habra, California

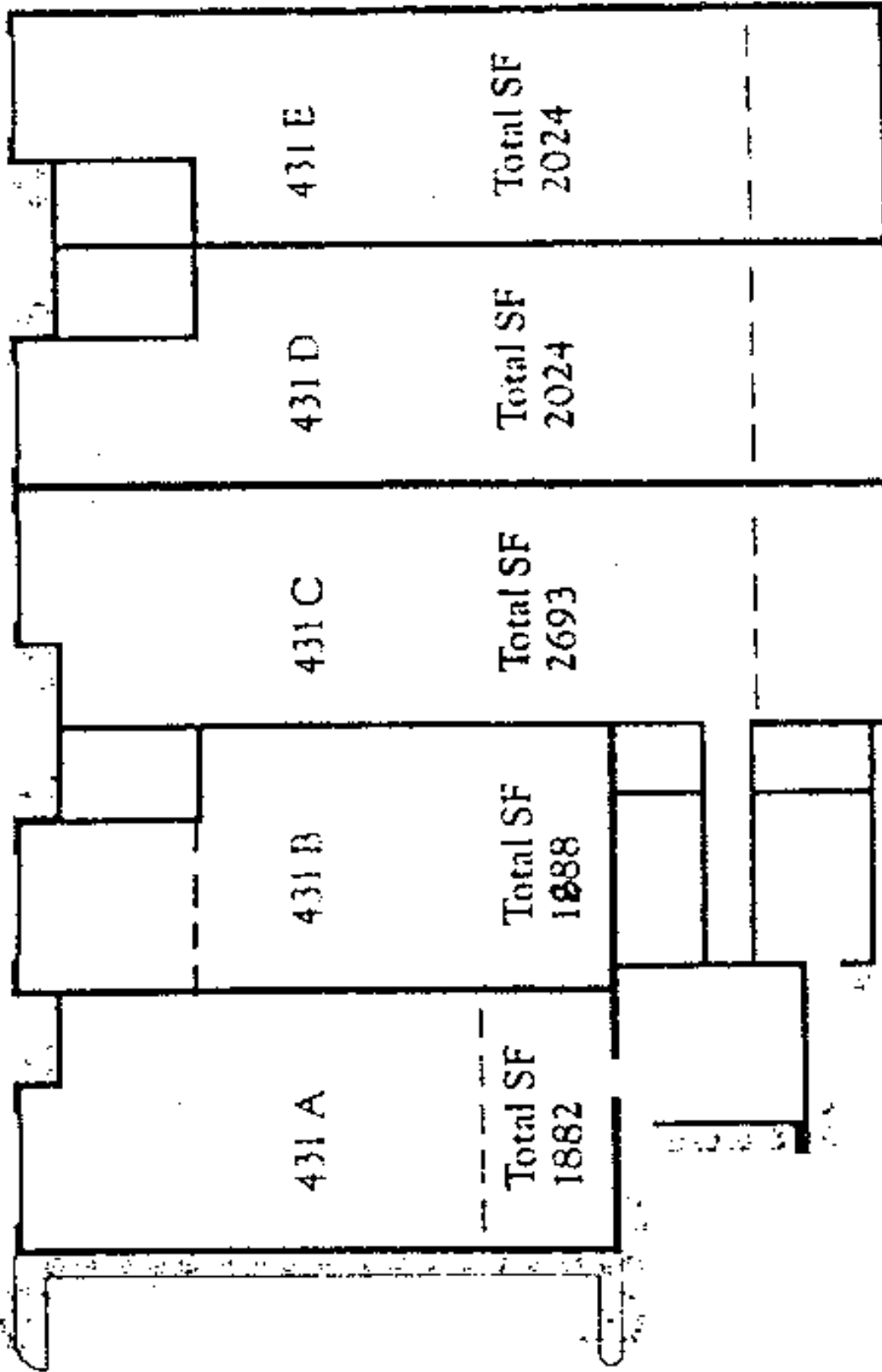

The information above has been obtained from sources believed reliable. While we do not doubt its accuracy, we have not verified it and make no guarantee, warranty or representation about it. It is your responsibility to confirm its accuracy and completeness. Any projections, opinions, assumptions or estimates used are for example only and do not represent the current or future performance of the property. The value of this transaction to you depends on tax, and other factors which should be evaluated by your tax, financial and legal advisors. You and your advisers should conduct a careful, independent investigation of the property to determine to your satisfaction the suitability of the property for your needs.