

ZUMA BUSINESS PARK

77,000 Square Feet of Industrial / Office Suites

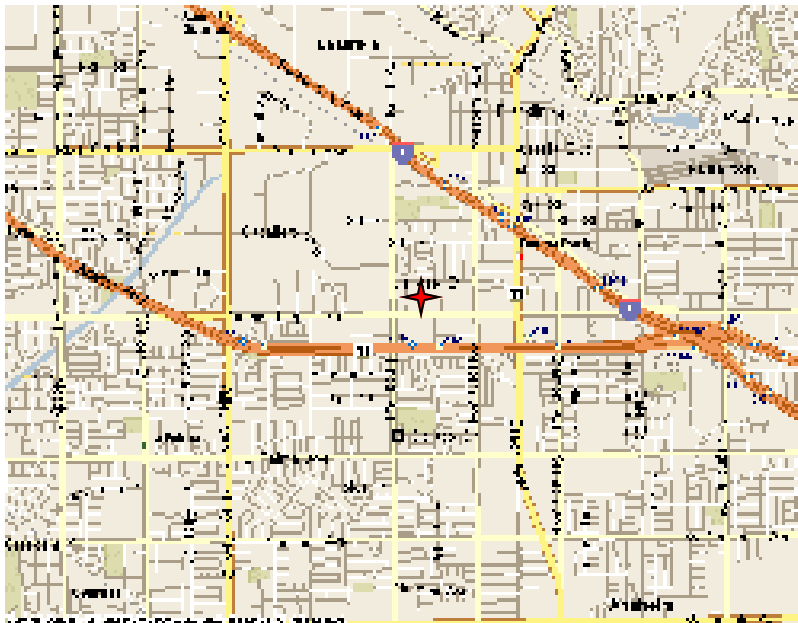

Orange thorp e Ave ./Knott Ave . - Buena Park, CA



Property Features:

Industrial / Office Units:

- *Well Maintained Business Park*
- *Responsive Management*
- *Units range between 300 to 3,500 sf*
- *Functional Lay-Out*
- *Efficient Sizes*
- *10% to 100% improved office area*
- *12' to 18' warehouse clearance*
- *Near the Riverside (91), and Santa Ana (5) Freeways*

For Leasing Information Please Contact:

Leasing Office (714) 237-7032

Susan Lee — slee@cedarem.com

www.cedarem.com

4055 La Palma Ave., Suite H-1, Anaheim, CA 92807



ZUMA BUSINESS PARK

Orangethorpe Ave. & Oslo Circle — Buena Park, California

6895, 6900, 6905 & 6910 Oslo Circle
 Buena Park, CA 90621
 Multi-tenant Industrial Units
 2 Small Office Buildings

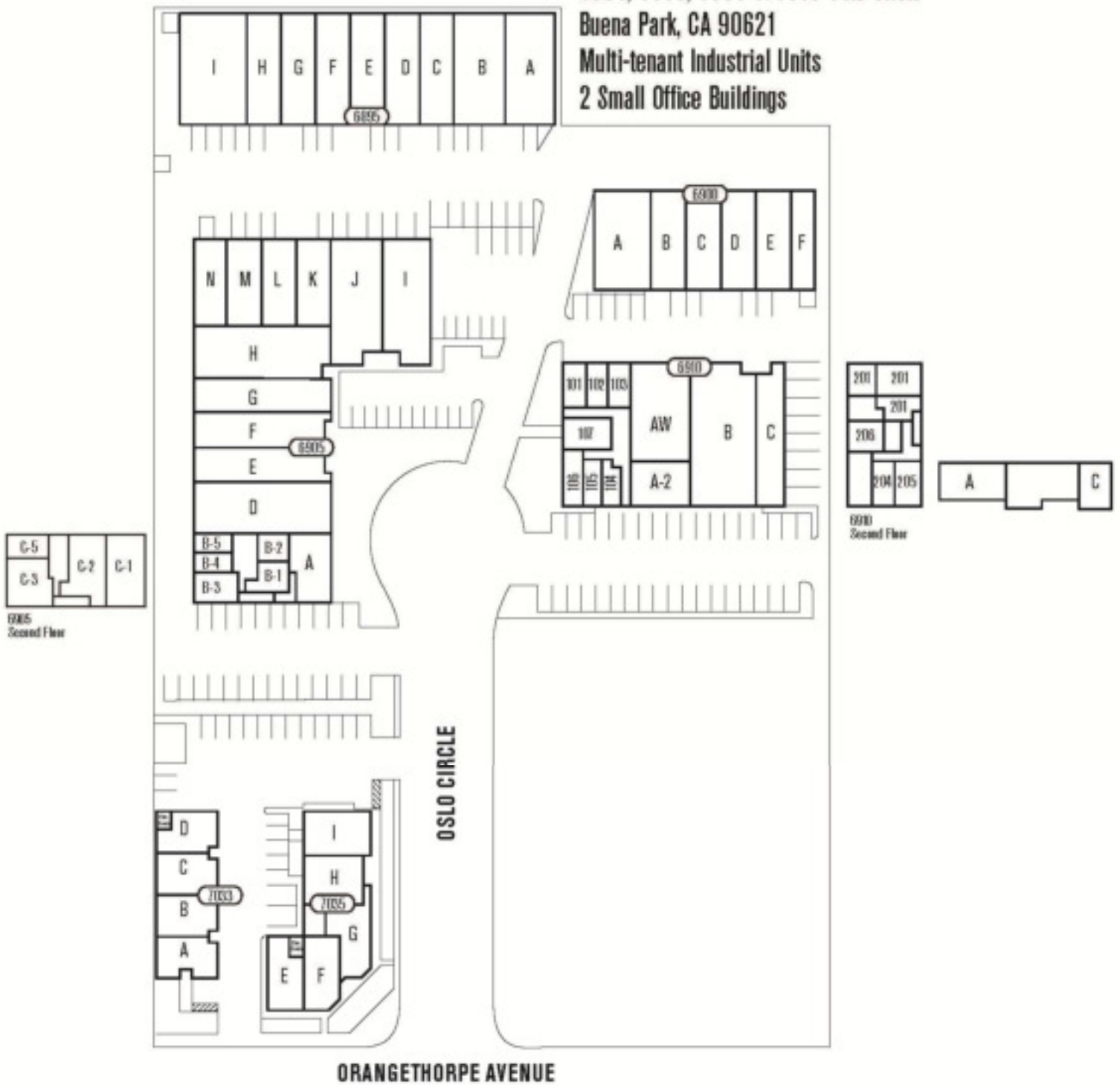

← Intersection of Orangethorpe Avenue & Knott Avenue

The information above has been obtained from sources believed reliable. While we do not doubt its accuracy, we have not verified it and make no guarantee, warranty or representation about it. It is your responsibility to confirm its accuracy and completeness. Any projections, opinions, assumptions or estimates used are for example only and do not represent the current or future performance of the property. The value of this transaction to you depends on tax, and other factors which should be evaluated by your tax, financial and legal advisors. You and your advisers should conduct a careful, independent investigation of the property to determine to your satisfaction the suitability of the property for your needs.